

CATÁLOGO

DE

ACCESORIOS

* Despiece de oscilobatiente hoja activa.

* Series RK-80,RK-65

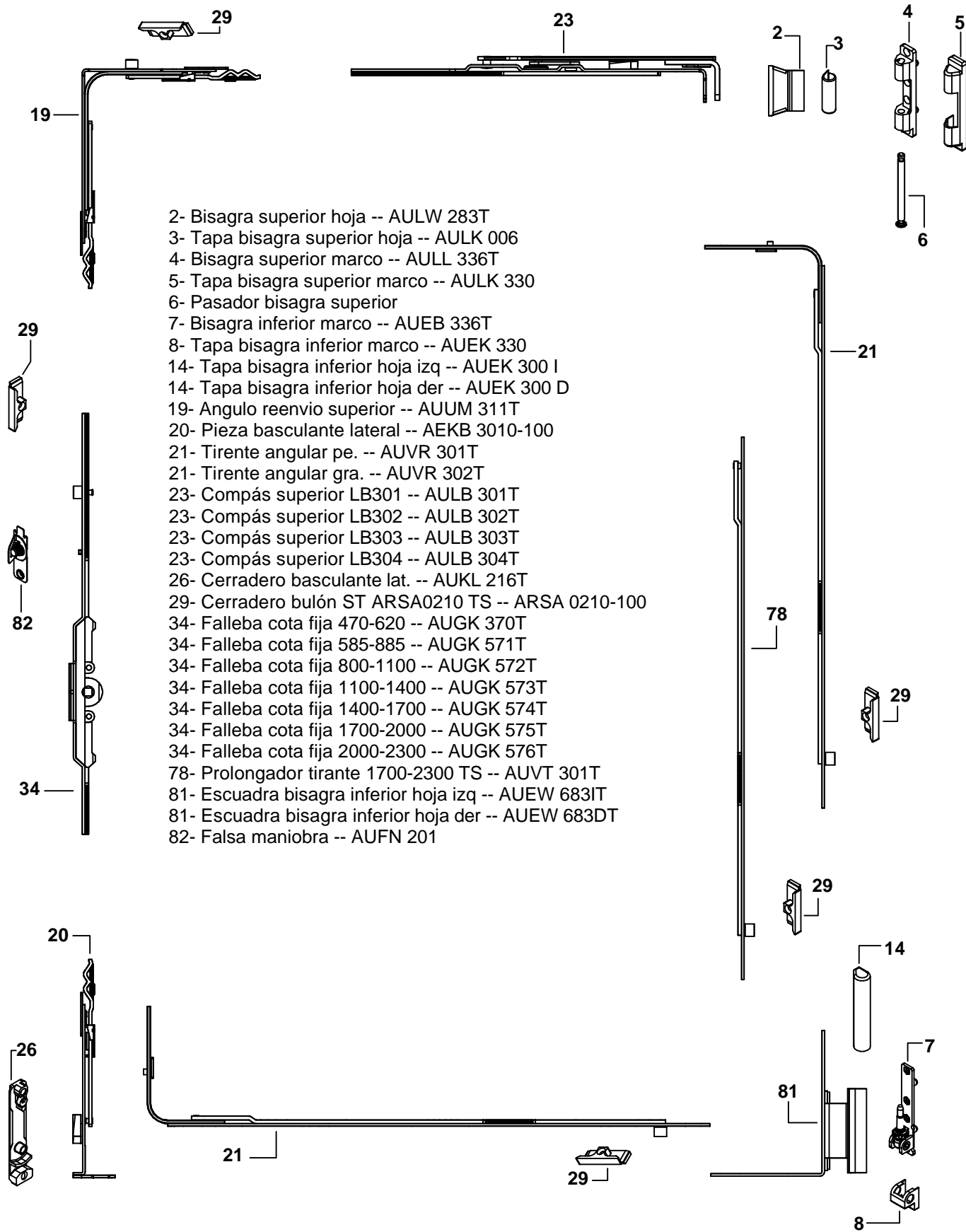
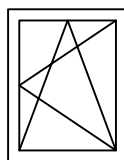

- 2- Bisagra superior hoja -- AULW 283T
- 3- Tapa bisagra superior hoja -- AULK 006
- 4- Bisagra superior marco -- AULL 336T
- 5- Tapa bisagra superior marco -- AULK 330
- 6- Pasador bisagra superior
- 7- Bisagra inferior marco -- AUEB 336T
- 8- Tapa bisagra inferior marco -- AUEK 330
- 14- Tapa bisagra inferior hoja izq -- AUEK 300 I
- 14- Tapa bisagra inferior hoja der -- AUEK 300 D
- 19- Angulo reenvio superior -- AUUM 311T
- 20- Pieza basculante lateral -- AEKB 3010-100
- 21- Tirente angular pe. -- AUVR 301T
- 21- Tirente angular gra. -- AUVR 302T
- 23- Compás superior LB301 -- AULB 301T
- 23- Compás superior LB302 -- AULB 302T
- 23- Compás superior LB303 -- AULB 303T
- 23- Compás superior LB304 -- AULB 304T
- 26- Cerradero basculante lat. -- AUKL 216T
- 29- Cerradero bulón ST ARSA0210 TS -- ARSA 0210-100
- 34- Falleba cota fija 470-620 -- AUGK 370T
- 34- Falleba cota fija 585-885 -- AUGK 571T
- 34- Falleba cota fija 800-1100 -- AUGK 572T
- 34- Falleba cota fija 1100-1400 -- AUGK 573T
- 34- Falleba cota fija 1400-1700 -- AUGK 574T
- 34- Falleba cota fija 1700-2000 -- AUGK 575T
- 34- Falleba cota fija 2000-2300 -- AUGK 576T
- 78- Prolongador tirante 1700-2300 TS -- AUVT 301T
- 81- Escuadra bisagra inferior hoja izq -- AUEW 683IT
- 81- Escuadra bisagra inferior hoja der -- AUEW 683DT
- 82- Falsa maniobra -- AUFN 201

* Despiece de practicable hoja activa.

* Series RK-80,RK-65

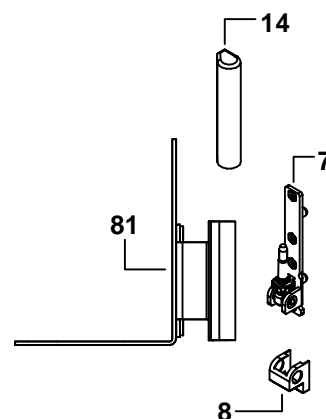
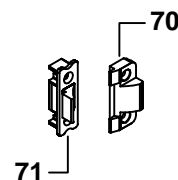
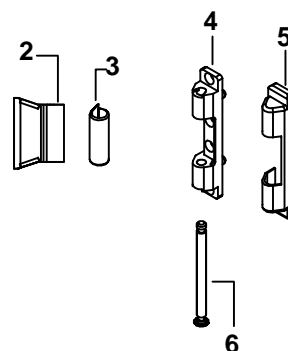
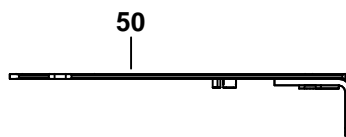
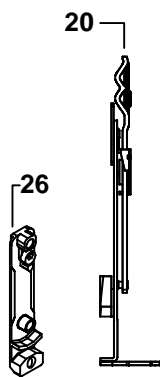
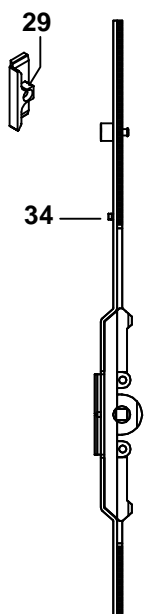
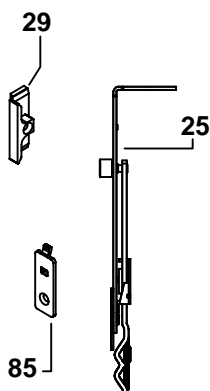
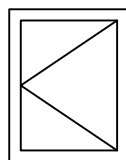

- 2- Bisagra superior hoja -- AULW 283T
- 3- Tapa bisagra superior hoja -- AULK 006
- 4- Bisagra superior marco -- AULL 336T
- 5- Tapa bisagra superior marco -- AULK 330
- 6- Pasador bisagra superior
- 7- Bisagra inferior marco -- AUEB 336T
- 8- Tapa bisagra inferior marco -- AUEK 330
- 14- Tapa bisagra inferior hoja izq -- AUEK 300 I
- 14- Tapa bisagra inferior hoja der -- AUEK 300 D
- 20- Pieza basculante lateral -- AEKB 3010-100
- 25- Complemento practicable -- AUDV 310T
- 26- Cerradero basculante lat. -- AUKL 216T
- 29- Cerradero bulón ST ARSA0210 TS -- ARSA 0210-100
- 34- Falleba cota fija 470-620 -- AUGK 370T
- 34- Falleba cota fija 585-885 -- AUGK 571T
- 34- Falleba cota fija 800-1100 -- AUGK 572T
- 34- Falleba cota fija 1100-1400 -- AUGK 573T
- 34- Falleba cota fija 1400-1700 -- AUGK 574T
- 34- Falleba cota fija 1700-2000 -- AUGK 575T
- 34- Falleba cota fija 2000-2300 -- AUGK 576T
- 50- Falso compás 501 universal -- AUBD 301T
- 70- Cierre central oculto marco -- AUBM 547G
- 71- Cierre central oculto hoja -- CCOHT
- 81- Escuadra bisagra inferior hoja izq -- AUEW 683IT
- 81- Escuadra bisagra inferior hoja der -- AUEW 683DT
- 85- Limitador recorrido ang. 90° -- AUDB 301

* Despiece de oscilobatiente y practicable hoja p siva.

* Series RK-80,RK-65

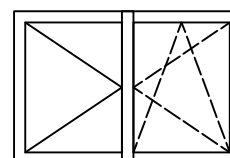

- 2- Bisagra superior hoja -- AULW 283T
- 3- Tapa bisagra superior hoja -- AULK 006
- 4- Bisagra superior marco -- AULL 336T
- 5- Tapa bisagra superior marco -- AULK 330
- 6- Pasador bisagra superior
- 7- Bisagra inferior marco -- AUEB 336T
- 8- Tapa bisagra inferior marco -- AUEK 330
- 14- Tapa bisagra inferior hoja izq -- AUEK 300 I
- 14- Tapa bisagra inferior hoja der -- AUEK 300 D
- 28- Cerradero bul n ST 031 TS -- AUST 031T (Solo practicable)
- 30- Cerradero bul n ST 034 TS -- AUST 034T
- 50- Falso comp s 501 universal -- AUBD 301T
- 55- Cerradero pasador SL-641 TS -- AUSL 641T
- 60- Pasador inferior SR-620 TS -- AUSR 620T
- 61- Pasador superior SR-320 TS -- AUSR 320T
- 62- Pasador superior SR-703 TS -- AUSR 703T (Solo oscilobatiente)
- 70- Cierre central oculto marco -- AUBM 547G
- 71- Cierre central oculto hoja -- CCOHT
- 81- Escuadra bisagra inferior hoja izq -- AUEW 683IT
- 81- Escuadra bisagra inferior hoja der -- AUEW 683DT

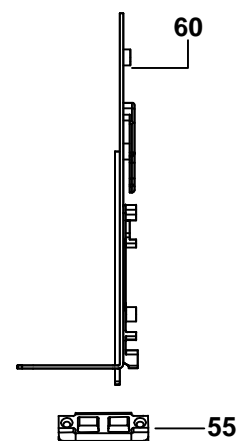
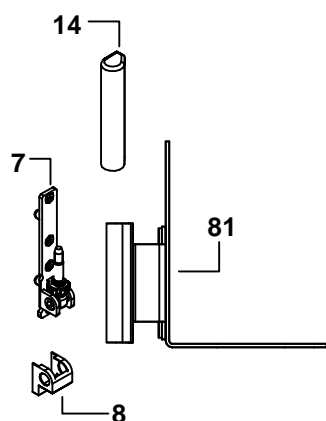
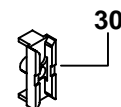
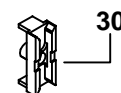
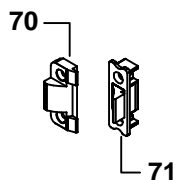
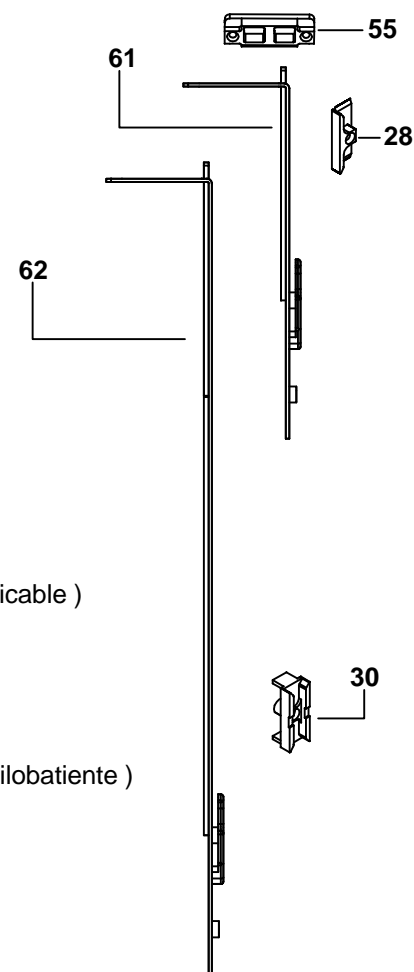

* Despiece de oscilobatiente y practicable hoja p siva con falleba.

* Series RK-80,RK-65

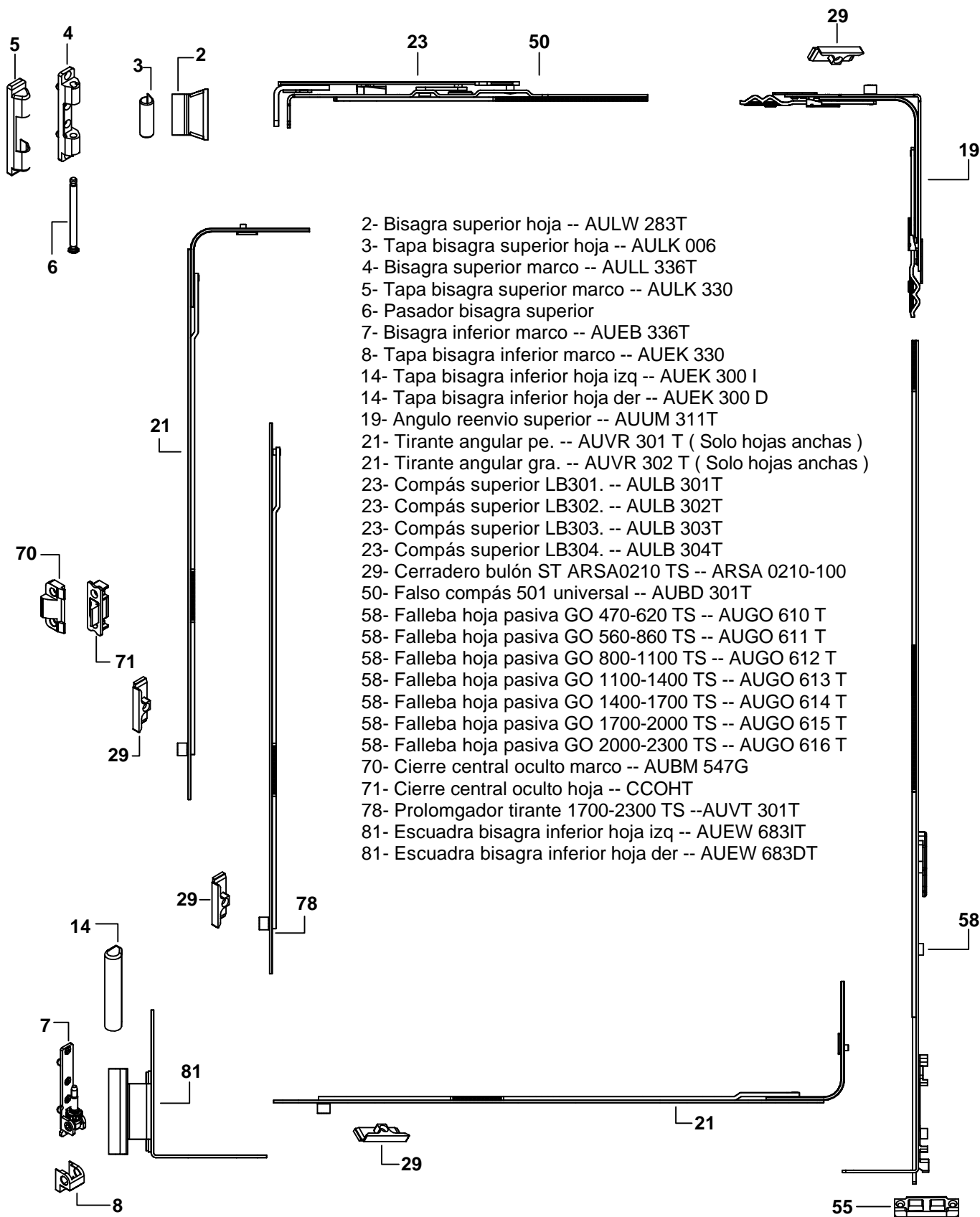
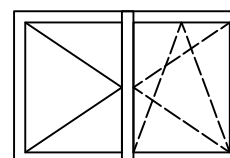

- 2- Bisagra superior hoja -- AULW 283T
- 3- Tapa bisagra superior hoja -- AULK 006
- 4- Bisagra superior marco -- AULL 336T
- 5- Tapa bisagra superior marco -- AULK 330
- 6- Pasador bisagra superior
- 7- Bisagra inferior marco -- AUEB 336T
- 8- Tapa bisagra inferior marco -- AUEK 330
- 14- Tapa bisagra inferior hoja izq -- AUEK 300 I
- 14- Tapa bisagra inferior hoja der -- AUEK 300 D
- 19- Angulo reenvio superior -- AUUM 311T
- 21- Tirante angular pe. -- AUVR 301 T (Solo hojas anchas)
- 21- Tirante angular gra. -- AUVR 302 T (Solo hojas anchas)
- 23- Comp s superior LB301. -- AULB 301T
- 23- Comp s superior LB302. -- AULB 302T
- 23- Comp s superior LB303. -- AULB 303T
- 23- Comp s superior LB304. -- AULB 304T
- 29- Cerradero bul n ST ARSA0210 TS -- ARSA 0210-100
- 50- Falso comp s 501 universal -- AUBD 301T
- 58- Falleba hoja pasiva GO 470-620 TS -- AUGO 610 T
- 58- Falleba hoja pasiva GO 560-860 TS -- AUGO 611 T
- 58- Falleba hoja pasiva GO 800-1100 TS -- AUGO 612 T
- 58- Falleba hoja pasiva GO 1100-1400 TS -- AUGO 613 T
- 58- Falleba hoja pasiva GO 1400-1700 TS -- AUGO 614 T
- 58- Falleba hoja pasiva GO 1700-2000 TS -- AUGO 615 T
- 58- Falleba hoja pasiva GO 2000-2300 TS -- AUGO 616 T
- 70- Cierre central oculto marco -- AUBM 547G
- 71- Cierre central oculto hoja -- CCOHT
- 78- Prolongador tirante 1700-2300 TS --AUVT 301T
- 81- Escuadra bisagra inferior hoja izq -- AUEW 683IT
- 81- Escuadra bisagra inferior hoja der -- AUEW 683DT

* Despiece de abatible.

* Series RK-80,RK-65

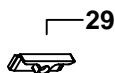
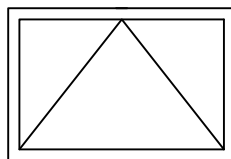

16

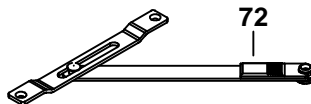

- 3- Tapa bisagra superior hoja -- AULK 006
- 4- Bisagra superior marco -- AULL 336T
- 5- Tapa bisagra superior marco -- AULK 330
- 6- Pasador bisagra superior
- 16- Falleba cota variable. ag.15.5 340-400 TS -- AGMD 1010-100
- 16- Falleba cota variable. ag.15.5 401-600 TS -- AGMD 1020-100
- 16- Falleba cota variable. ag.15.5 601-800 TS -- AGMD 1030-100
- 16- Falleba cota variable. ag.15.5 801-1000 TS -- AGMD 1040-100
- 16- Falleba cota variable. ag.15.5 1001-1200 TS -- AGMD 1050-100
- 16- Falleba cota variable. ag.15.5 1201-1400 TS -- AGMD 1060-100
- 29- Cerradero bulón ST ARSA0210 TS -- ARSA 0210-100
- 30- Bisagra abatible KB 583 T-- AUKB 583T
- 72-Compás abatible 420-1520 TS -- ASKF 0010-100

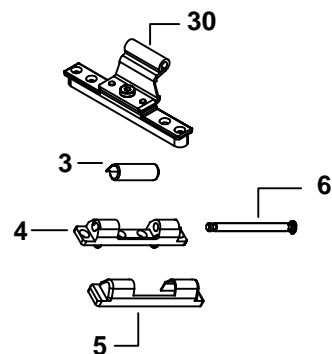
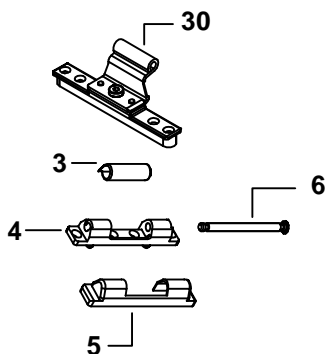

* Despiece de practicable PS1

* Series RK-80

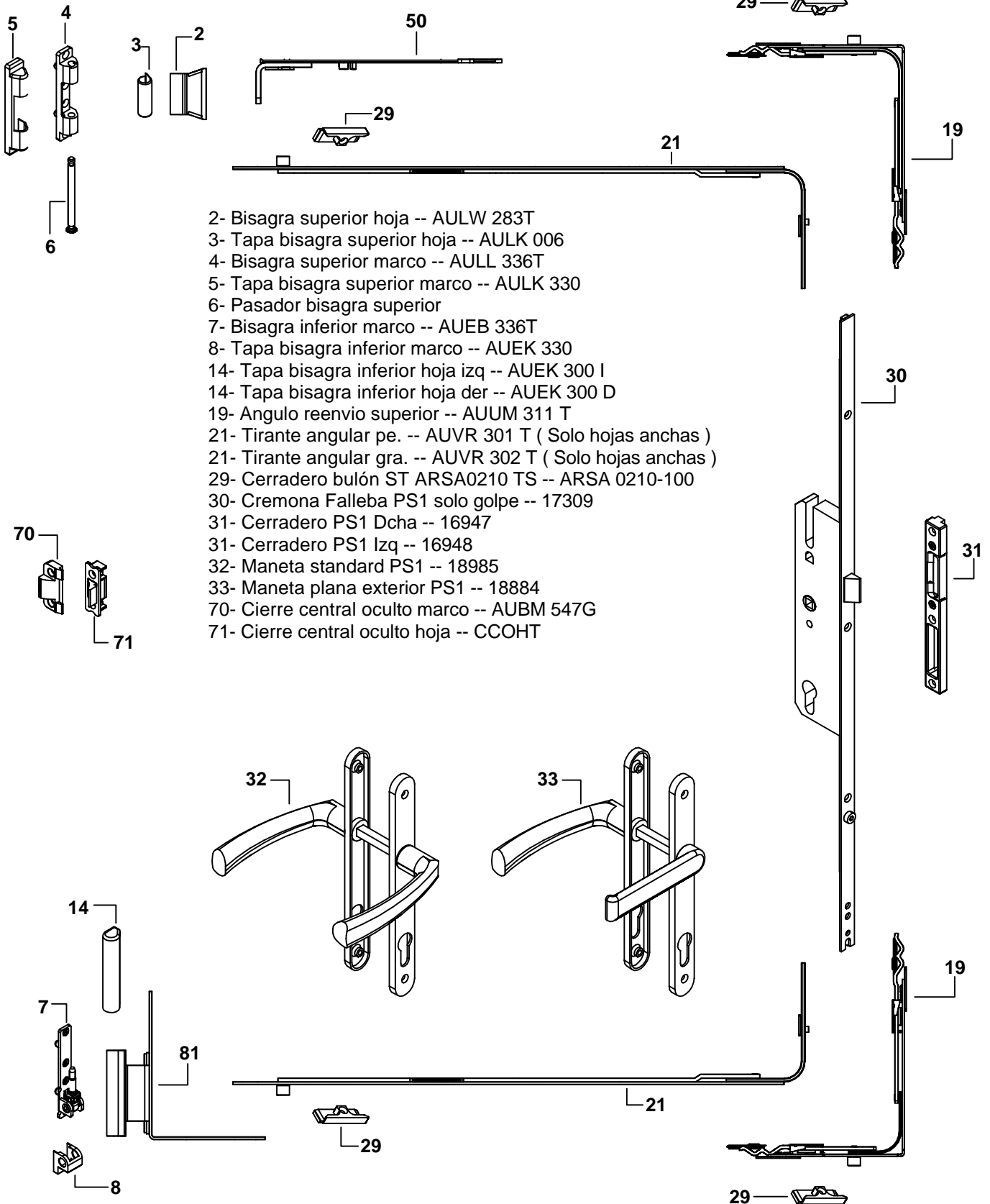
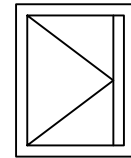

- 2- Bisagra superior hoja -- AULW 283T
- 3- Tapa bisagra superior hoja -- AULK 006
- 4- Bisagra superior marco -- AULL 336T
- 5- Tapa bisagra superior marco -- AULK 330
- 6- Pasador bisagra superior
- 7- Bisagra inferior marco -- AUEB 336T
- 8- Tapa bisagra inferior marco -- AUEK 330
- 14- Tapa bisagra inferior hoja izq -- AUEK 300 I
- 14- Tapa bisagra inferior hoja der -- AUEK 300 D
- 19- Angulo reenvio superior -- AUUM 311 T
- 21- Tirante angular pe. -- AUVR 301 T (Solo hojas anchas)
- 21- Tirante angular gra. -- AUVR 302 T (Solo hojas anchas)
- 29- Cerradero bulón ST ARSA0210 TS -- ARSA 0210-100
- 30- Cremona Falleba PS1 solo golpe -- 17309
- 31- Cerradero PS1 Dcha -- 16947
- 31- Cerradero PS1 Izq -- 16948
- 32- Maneta standard PS1 -- 18985
- 33- Maneta plana exterior PS1 -- 18884
- 70- Cierre central oculto marco -- AUBM 547G
- 71- Cierre central oculto hoja -- CCOHT

* Despiece de plasticos.

* Series RK-80,RK-65

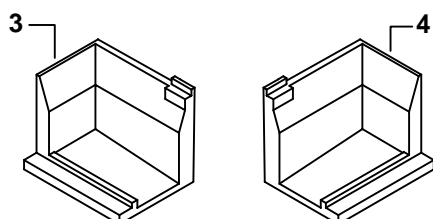
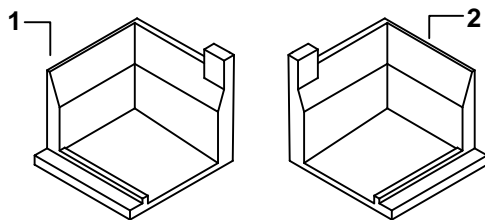
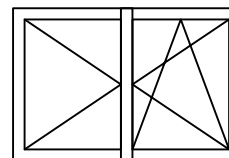

- 1- Alineación marco RK-80 iz. -- RK80I
- 2- Alineación marco RK-80 de. -- RK80D
- 3- Alineación marco RK-65 iz. -- RK65I
- 4- Alineación marco RK-65 de. -- RK65D
- 5- Exterior inversor RK-80 -- RK80-EX
- 6- Exterior inversor RK-65 -- RK65-EX
- 7- Interior inversor RK -- RK-INVER
- 8- Regulador corto --13380-NOIR
- 9- Tornillo cilind. ZN AW 4,8x45 -- 2064845
- 10- Regulador largo 65-12 DIAN -- EP-2009L
- 11- Tornillo cilind. ZN AW 4,8x80 -- 2064880
- 12- Tapon regulador 18 negro -- TAP-018

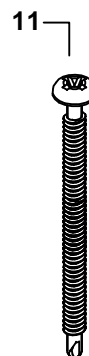
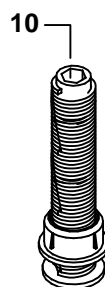
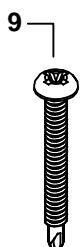
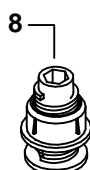
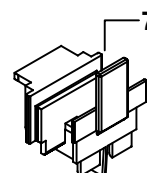
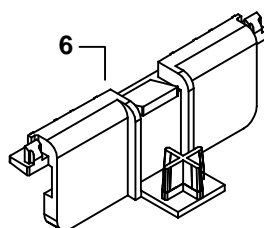
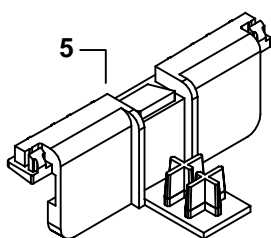

* Despiece de corredera series KL-C y KL-GE.

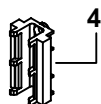
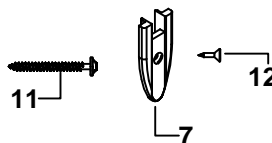
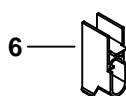
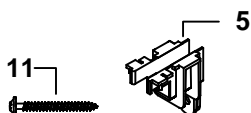
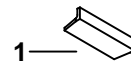
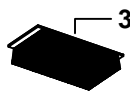
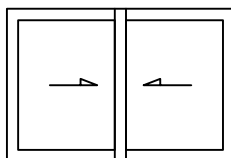

- 1- Estancador esquina -- 14223
- 2- Cortavientos inferior -- 14201
- 3- Cortavientos superior -- 14197
- 4- Calzo hoja lateral -- 15718
- 5- Tope hoja lateral -- 14187
- 6- Tope cruce -- 15828
- 7- Tapa cruce -- 15670
- 8- Tapa desagüe -- 16891
- 9- Cojinete balconera -- 14226
- 10- Cojinete ventana -- 14225
- 11- Tornillo casaca -- 14427
- 12- Tornillo tapa cruce -- 11472

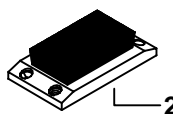
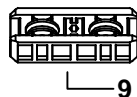
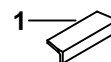
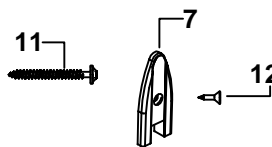
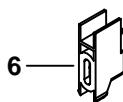
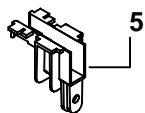
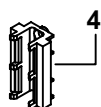

* Despiece de corredera series KL-C y KL-GE.

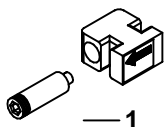
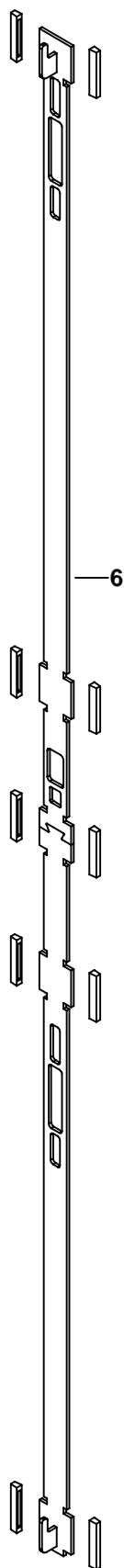
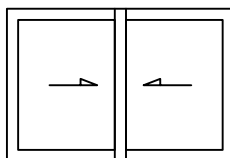

1

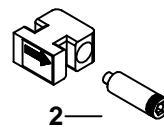

2

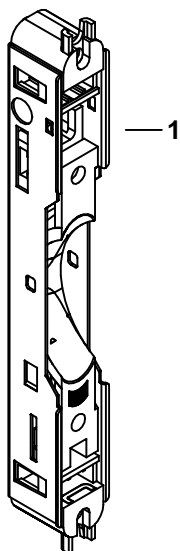

1

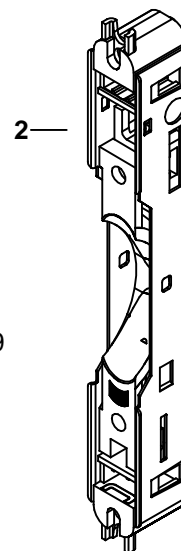

2

- 1- Cierre izquierdo -- 16790
- 2- Cierre derecho -- 16347
- 3- Gancho cierre izquierdo -- 16286
- 4- Gancho cierre derecho -- 16285
- 5- Tapa embellecedora cierre -- 16339
- 6- Multipunto triple -- 17754

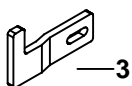

3

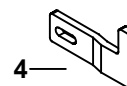

4

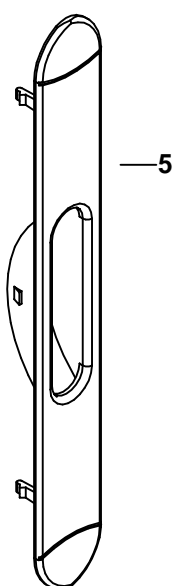

5

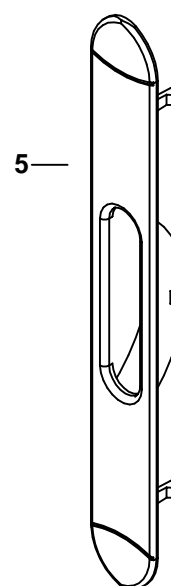

5

* Despiece de corredera series KL-C y KL-GE.

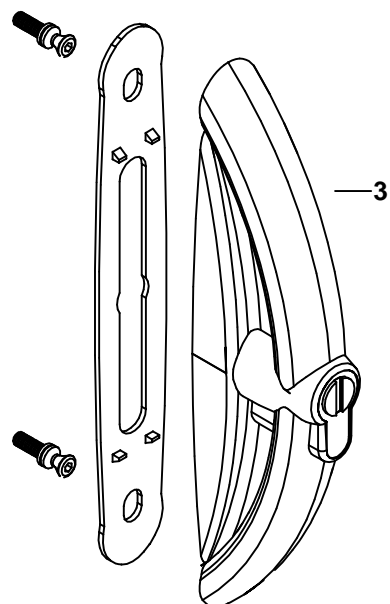
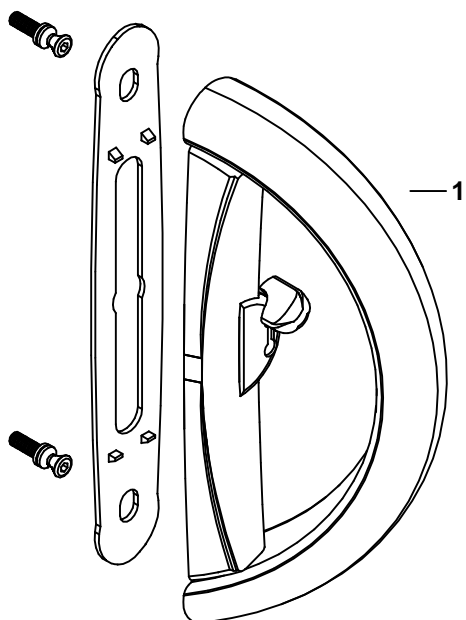
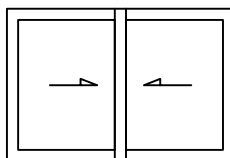

- 1- Cierre tirador -- 16342
- 2- Tirador interior -- 16343
- 3- Uñero llave exterior -- 16690
- 4- Uñero exterior -- 16340

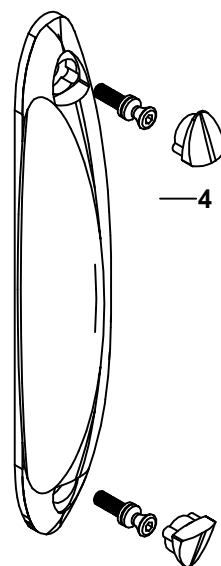
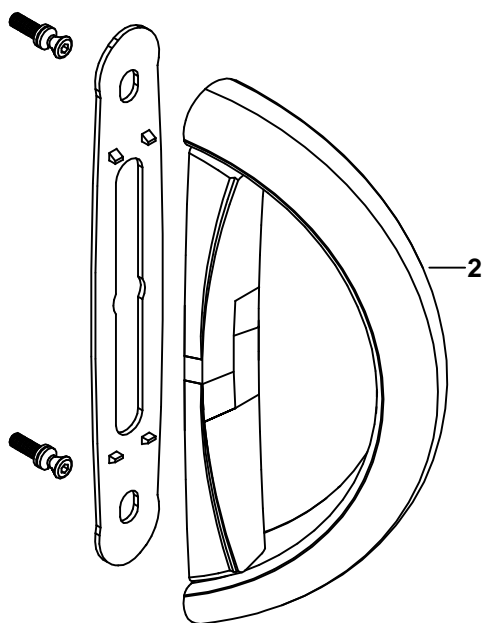

* Despiece de corredera series KL-C y KL-GE.

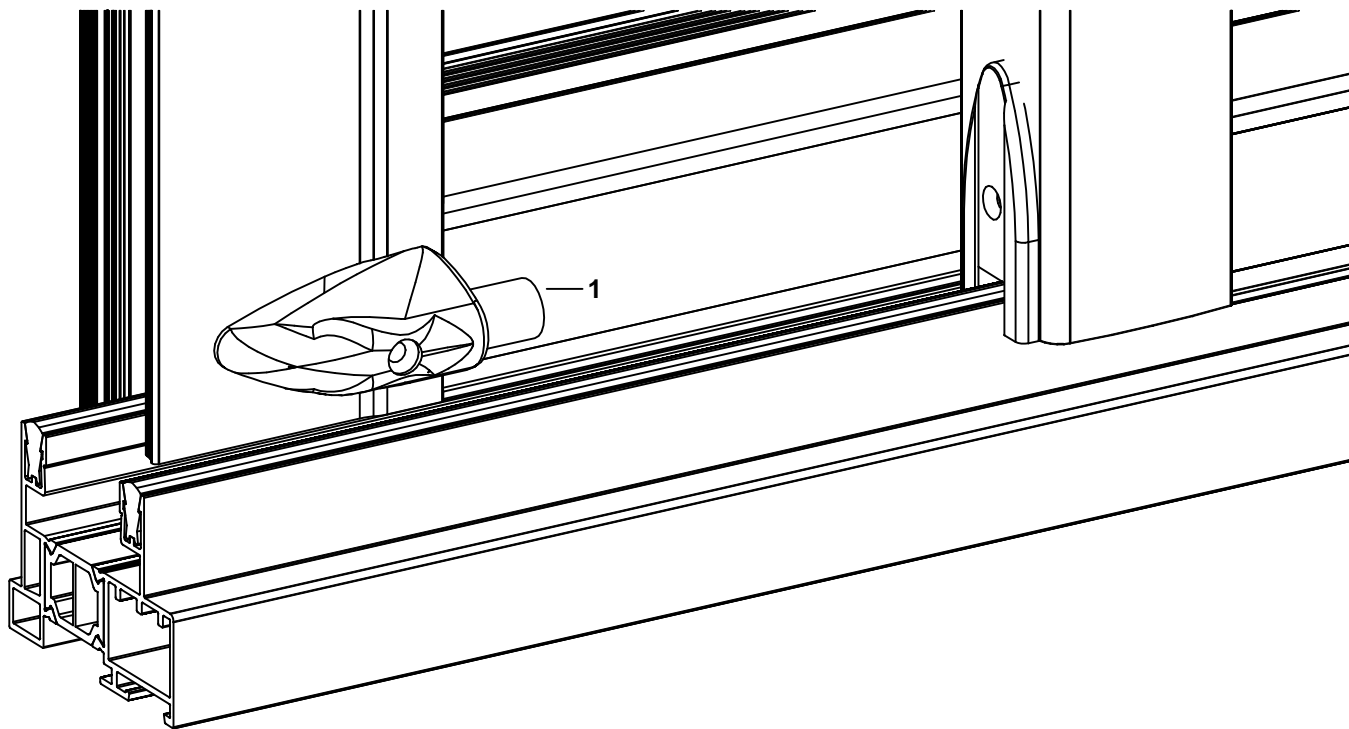
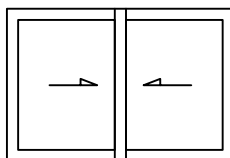

1- Tope final de carrera KL-C -- 14422

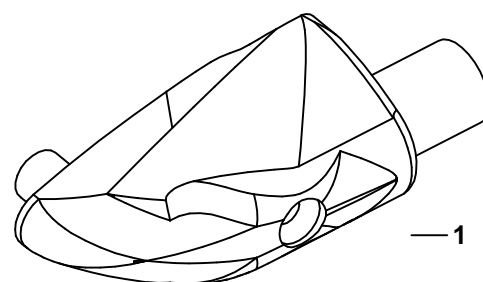
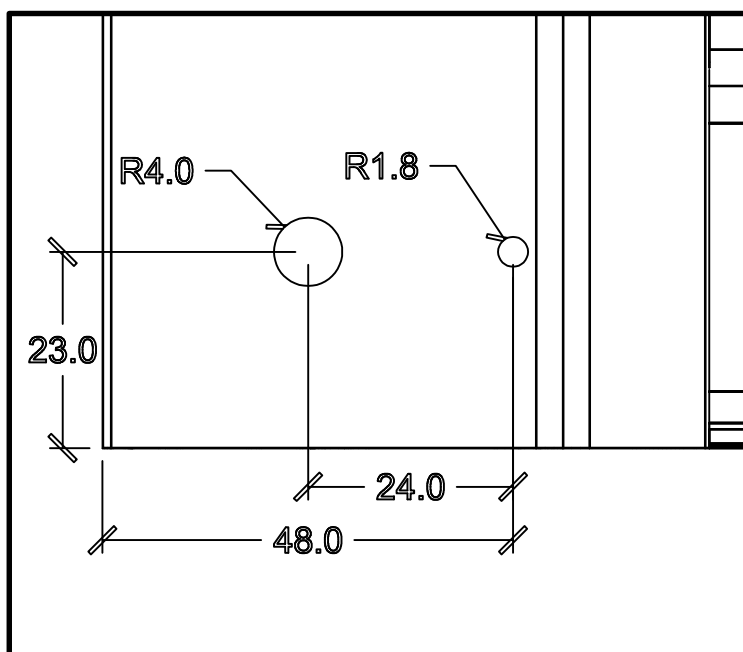

2- Mecanización del Tope final de carrera KL-C

* Despiece de corredera serie RQ-75.

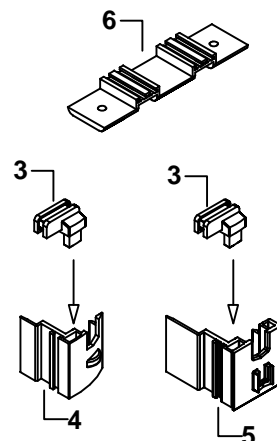
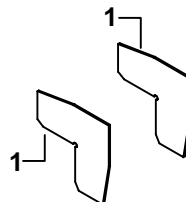
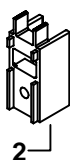
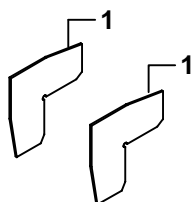
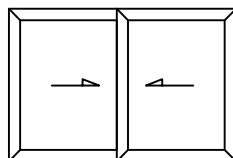

- 1- Alineacion hojas -- RQ-19
- 2- Tope de hoja -- TH-75
- 3- Apendices cruce -- ATC-75
- 4- Topes de cruce curvos -- TC-75 L
- 5- Topes de cruce recto -- TC-75-R
- 6- Corta vientos standard -- CV-75
- 7- Calzo cojinete -- CC-75
- 8- Cojinete balconera -- 111-E615-A
- 9- Cojinete ventana -- 111-E615-A

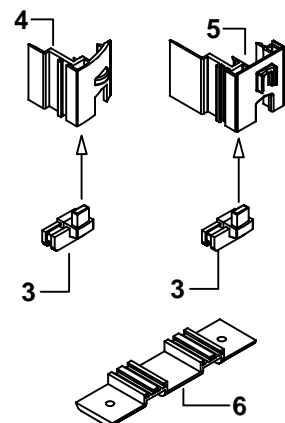
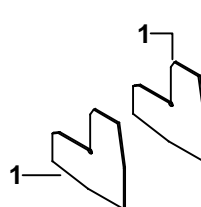
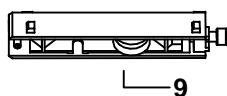
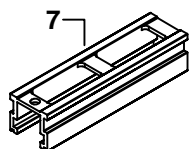
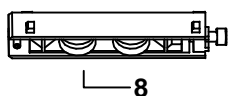
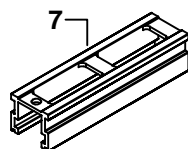
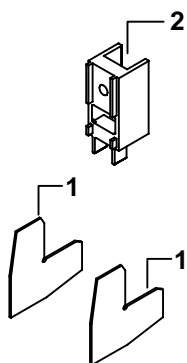

* Despiece de corredera serie RQ-75 Y RQ-70.

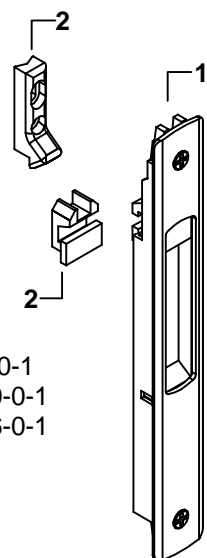
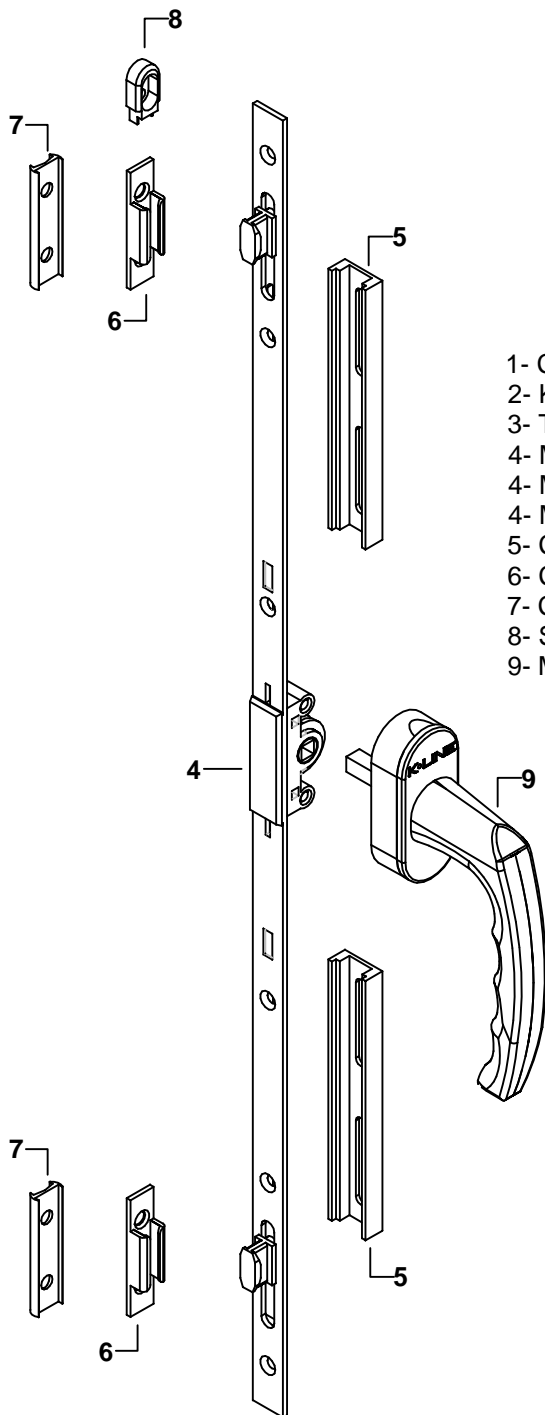
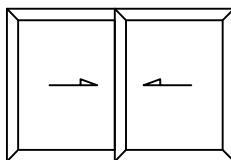

- 1- Cierre delta -- 10100
- 2- Kit gancho delta -- 2251014
- 3- Tirador beta -- 70101
- 4- Multipunto corredera L 600 -- G-13954-06-0-1
- 4- Multipunto corredera L 1000 -- G-13954-10-0-1
- 4- Multipunto corredera L 1600 -- G-13954-16-0-1
- 5- Calce muntipunto -- 120-20-9
- 6- Cerradero corredera -- E-13880-00-0-1
- 7- Calce cerradero -- 55-12-EZ
- 8- Seguro antielevacion -- E-18196-00-0-1
- 9- Manilla atlanta -- HPMAN530C24

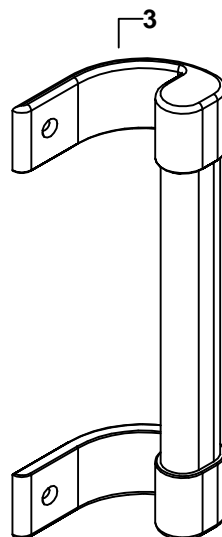

* Despiece de corredera serie RQ-70.

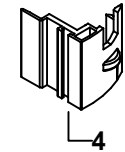
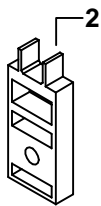
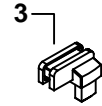
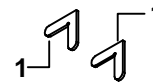
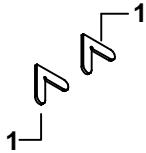
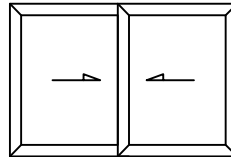

- 1- Alineacion hojas -- RQ-9
- 2- Tope de hoja -- TH-ECO
- 3- Apendices cruce -- TC-ECO
- 4- Topes de cruce curvos -- TC-ECO
- 5- Cojinete balconera -- 561A.1
- 9- Cojinete ventana -- 361A

